



**AEM**® Innovation to **power** your vision

# What's **NEW**@



**AEM**®  
COMPONENTS

**Circuit protection for automotive, industrial, & commercial applications**

## **SolidMatrix® Fuses**

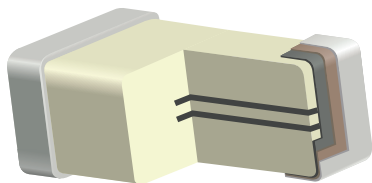

### **Features**

- Robust co-fired monolithic construction
- Best-in-class volumetric efficiency
- Excellent inrush current withstanding capability

## **AirMatrix® Fuses**

**AEC-Q200 Qualified**

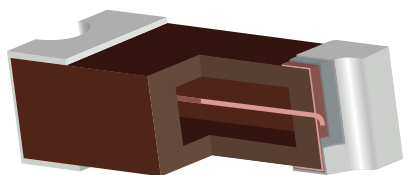

### **Features**

- Robust solderless construction
- Best-in-class volumetric efficiency
- Superior performance in extremely harsh conditions

## **CMF High Power Fuses**

**AEC-Q200 Qualified**

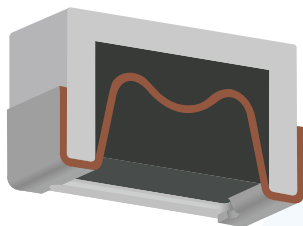

### **Features**

- 2822 package size for 20A to 125A (150A & 200A available)
- Best-in-class ESR & Safe Power Density
- Outstanding arc suppression characteristics

## **EV Fuses**

**AEC-Q200 Qualified**

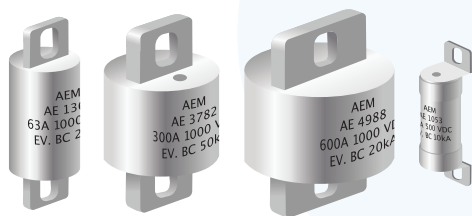

### **Features**

- High current – High voltage designs up to 600A & 1kVdc
- Compact bolt-in designs
- Superior arc suppression characteristics

**Contact Our Solution  
Solving Sales Team**



<https://bit.ly/4l5I0RR>